

Wohnungen Nauheimer Straße 2

Grundriss A

1,5-Zimmer-Wohnung,
ca. 48 qm, Küche,
Dusche, WC, Balkon

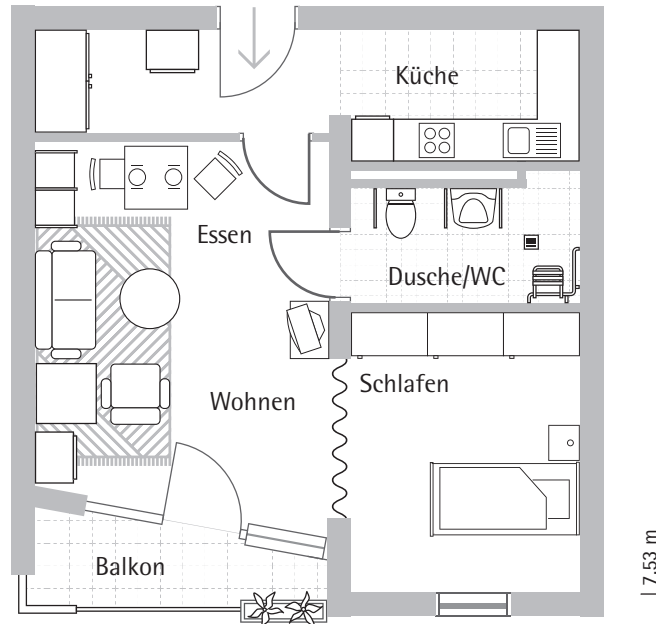

7.27 m

1.00 m

Grundriss B

1-Zimmer-Wohnung,
ca. 36 qm, Küche,
Dusche, WC, Balkon

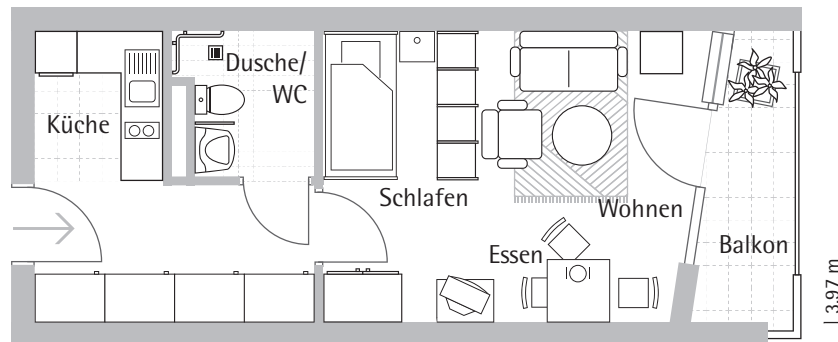

8.95 m

1.00 m

Grundriss C

1,5-Zimmer-Wohnung,
ca. 49 qm, Küche,
Dusche, WC, Balkon

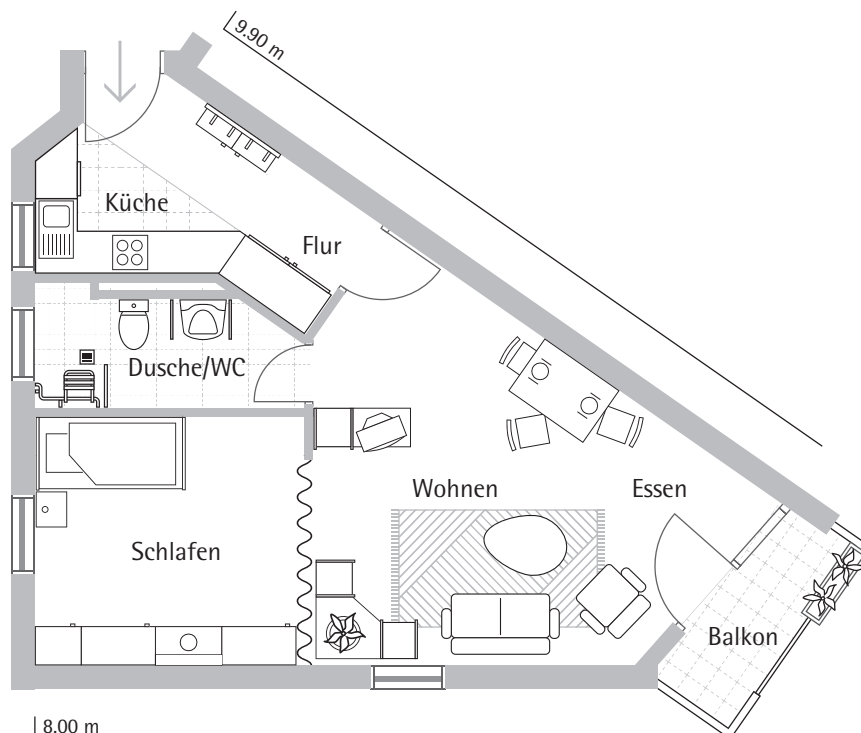

8.00 m

1.00 m